

**LARGE  
DOCUMENT  
SOLUTIONS**

(303) 773-9015  
(866) 338-4464

info@largedocumentsolutions.com  
www.largedocumentsolutions.com

7318 S. Revere Pkwy., Suite A-1  
Centennial, CO 80112

# Graphtec IS210HD<sup>PLUS</sup> PRO<sup>LC</sup>

## 8-bit color 42" Image Scanner

Color & monochrome solutions for large-format scanning and copying featuring the world's fastest scanning speeds with unbeatable accuracy.



State of the art scanning technology for GIS/CAD, Graphics, Reprographics and more.

**3** YEAR ON-SITE WARRANTY

42" wide

600dpi optical resolution, 9600dpi max

CIS scanning technology — high definition scans, no folded optics and no warm-up time

Scan speeds up to 9.0ips (monochrome) and 3.0ips (8-bit color) at 400dpi

Includes: Stand with mylar catch basket and mylar carrier sheet

0.1% scanning accuracy

Scanning Master21+ software included

USB 2.0 (high-speed) and ethernet plug 'n play connectivity

3 year on-site warranty

42"



up to 9600dpi

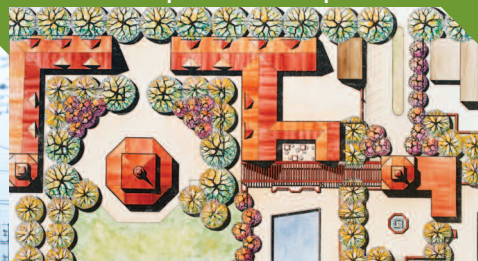

8-bit color



[www.largedocumentsolutions.com](http://www.largedocumentsolutions.com)

## PRO<sup>LC</sup> IS210 Specifications

<b>Document sizes</b>	ANSI E to ISO A4
<b>Maximum scanning medium width</b>	1,092mm (43inches) (centered)
<b>Effective scanning area</b>	1,066.8mm (42inches) (centered) Width & 999m (maximum) Length
<b>Document thickness</b>	1.5mm (0.06 inches) or less (including the carrier sheet)
<b>Optical resolution</b>	600 dpi
<b>Interpolated resolution</b>	50 to 9600 dpi
<b>Main scanning system</b>	Contact image sensor system (five A4 sensors in a zigzag pattern)
<b>Sub scanning system</b>	Document travel (sheet through) system
<b>Max. scanning speed @ 400dpi</b>	
<b>Monochrome</b>	9.0ips
<b>8-bit color</b>	3.0ips
<b>Scanning precision</b>	+/-0.1%
<b>Gradation</b>	Monochrome: Bilevel, intermediate tones (dithering, error diffusion) Gray : 256 shades, Color: 8-bit
<b>Threshold value</b>	Automatic threshold setting by DSP during monochrome mode
<b>Color space</b>	s-RGB compatible
<b>Light source</b>	LED (RGB)
<b>Interface</b>	USB 2.0 (High Interface speed), 10BASE-T/100BASE-TX
<b>Output</b>	Image data
<b>Rated power supply</b>	100 to 120/200 to 230 VAC +/-10%, 50/60 Hz
<b>Operating environment</b>	Temperature: 10° C to 35° C (50° F to 95° F); Humidity : 35% to 80% R.H. (non-condensing)
<b>Power consumption</b>	135 VA or less (60W or less) (5W or less in power save mode)
<b>External dimensions (approx.)</b>	1,205 x 957 x 717 mm (47.4 x 37.7 x 28.2 inches) (W x H x D) (including stand and basket)
<b>Weight (approx.)</b>	38 kg / 82 lbs (including stand)
<b>Conforming standard</b>	UL, FCC class A (USA), CE mark (EU), ccc, EK mark
<b>Operating system (OS)</b>	Windows Vista, Windows XP Professional, Windows XP Home edition, Windows 2000 Professional

**In the box: Scanner, catch sling, carrier sheet, USB cable, power cord and manual**



info@largedocumentsolutions.com ■ (866) 338-4464

www.largedocumentsolutions.com

**LARGE  
DOCUMENT  
SOLUTIONS**