

**LARGE
DOCUMENT
SOLUTIONS**

(303) 773-9015
(866) 338-4464

info@largedocuments.com
www.largedocuments.com

7318 S. Revere Pkwy., Suite A-1
Centennial, CO 80112

Graphtec IS210HD^{PLUS} Base & PRO

Black & White 42" Image Scanner

Monochrome solutions for large-format scanning and copying featuring the world's fastest scanning speeds with unbeatable accuracy.



State of the art scanning technology for GIS/CAD, Graphics, Reprographics and more.

3 YEAR ON-SITE WARRANTY

42" wide

600dpi optical resolution

CIS scanning technology — high definition scans, no folded optics and no warm-up time

Scan speeds up to 9.0ips monochrome (Pro) 4.5ips (Base)

Includes: Stand with mylar catch basket and mylar carrier sheet

0.1% scanning accuracy

Scanning Master21+ software included

USB 2.0 (high-speed) and ethernet plug 'n play connectivity

3 year on-site warranty

42"



up to 9600dpi

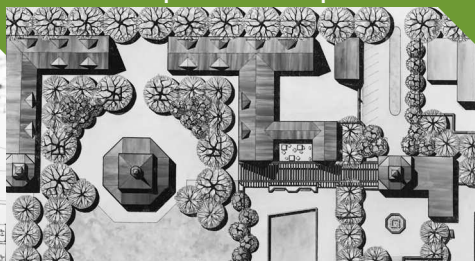

Gray scale



www.largedocuments.com

Base & PRO IS210 Specifications

Document sizes	ANSI E to ISO A4
Maximum scanning medium width	43inches (centered)
Effective scanning area	42inches (centered) Width & 999m (maximum) Length
Document thickness	0.06 inches or less (including the carrier sheet)
Optical resolution	600 dpi
Interpolated resolution	50 to 9600 dpi (PRO) 50 to 800 dpi (Base)
Main scanning system	Contact image sensor system (five A4 sensors in a zigzag pattern)
Sub scanning system	Document travel (sheet through) system
Max. scanning speed @ 400dpi	
Monochrome	9.0ips (PRO) 4.5ips (Base)
Scanning precision	+/-0.1%
Gradation	Monochrome: Bilevel, intermediate tones (dithering, error diffusion) Gray: 256 shades
Threshold value	Automatic threshold setting by DSP during monochrome mode
Color space	s-RGB compatible
Light source	LED (RGB)
Interface	USB 2.0 (High Interface speed), 10BASE-T/100BASE-TX
Output	Image data (tiff, tiff G4, pdf and other)
Rated power supply	100 to 120/200 to 230 VAC +/-10%, 50/60 Hz
Operating environment	Temperature: 10° C to 35° C (50° F to 95° F); Humidity : 35% to 80% R.H. (non-condensing)
Power consumption	135 VA or less (60W or less) (5W or less in power save mode)
External dimensions (approx.)	1,205 x 957 x 717 mm (47.4 x 37.7 x 28.2 inches) (W x H x D) (including stand and basket)
Weight (approx.)	38 kg / 82 lbs (including stand)
Conforming standard	UL, FCC class A (USA), CE mark (EU), ccc, EK mark
Operating system (OS)	Windows Vista, Windows XP Professional, Windows XP Home edition, Windows 2000 Professional



info@largedocuments.com ■ (866) 338-4464

www.largedocuments.com

LARGE
DOCUMENT
SOLUTIONS