

**LARGE
DOCUMENT
SOLUTIONS**

(303) 773-9015

(866) 338-4464

info@largedocuments.com
www.largedocuments.com

7318 S. Revere Pkwy., Suite A-1
Centennial, CO 80112

Graphtec CS500-06 Pro

25" Full-Color Image Scanner



Shown with optional stand

Color & monochrome solutions for large-format scanning and copying featuring the world's fastest scanning speeds with unbeatable accuracy.

3 YEAR ON-SITE WARRANTY

25" wide

0.1% scanning accuracy

CIS Contact Image Sensor method for quick start-up, crisp image reproduction & minimal maintenance

Maximum scanning speed of 9.0ips (monochrome) & 3.0ips Pro available (full-color) at 400dpi

Optional: Scanner stand

Standard Scanning Master21+ software: Scan-to-file, scan-to-print, scan-to-email or scan-to-PDF

600dpi optical resolution up to 4800dpi interpolated resolution

sRGB compatible

USB 2.0 (high-speed) & Ethernet Plug 'n' Play connectivity

25"

up to 4800dpi

full color

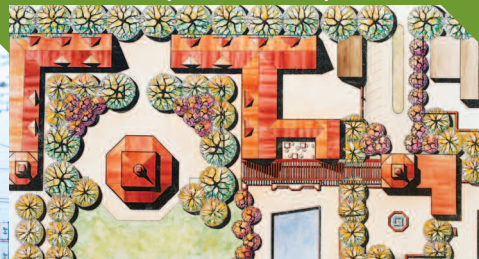

www.largedocumentsolutions.com

Graphtec CS500-06 Pro Specifications

Document sizes	ANSI D to ISO A4
Maximum scanning medium width	25inches (centered)
Effective sanning area	25inches (centered) Width & 999m (maximum) Length
Document thickness	1.5mm (0.06 inches) or less (including the carrier sheet)
Optical resolution	600 dpi
Interpolated resolution	50 to 4800 dpi in 1dpi increments
Main scanning system	Contact image sensor system
Sub scanning system	Document travel (sheet through) system
Max. scanning speed @ 400dpi	
Monochrome	9.0 ips
Color	3.0 ips
Scanning precision	0.1%, ± 5 pixels / 25" Monochrome : Bilevel, halftone grayscale simulation; Grayscale: 8-bit (256 level)
Threshold value	DSP (Digital Signal Processor) — controlled automatic setting for monochrome scans
Color space	s-RGB compatible
Light source	LED (RGB)
Interface	USB 2.0 and Ethernet
Output	Image data
Rated power supply	100 to 120/200 to 230 VAC $\pm 10\%$, 50/60 Hz
Operating environment	Temperature: 50° to 95° F; Humidity : 35% to 80% R.H. (non-condensing)
Power consumption	135 VA or less
External dimensions (approx.)	
Conforming standard	UL, FCC class A (USA), CE mark (EU)
Operating system (OS)	Windows® XP Professional®, Windows XP Home edition®, Windows 2000 Professional®
Weight (approx.)	



info@largedocuments.com ■ (866) 338-4464

www.largedocuments.com

**LARGE
DOCUMENT
SOLUTIONS**